

WHISPER WALK SECTION "D"

SITUATE IN SECTION 5, TOWNSHIP 47 SOUTH,
RANGE 42 EAST, PALM BEACH COUNTY, FLORIDA.
BEING A REPLAT OF A PORTION OF TRACT A OF
THE BOUNDARY PLAT OF WHISPER WALK, A P.U.D.
(PB. 43, PG. 189-191)

PREPARED BY:
CRAIG A. SMITH & ASSOCIATES
CONSULTING ENGINEERS & SURVEYOR'S
1000 WEST McNAB ROAD
POMPANO BEACH, FLORIDA, 33069
BY: FREDERICK E. CONROD, III, P.L.S. No. 2816
JULY 1987

STATE OF FLORIDA } S.S.
COUNTY OF PALM BEACH }
THIS PLAT WAS FILED FOR
RECORD AT 10:48 AM THIS 9
DAY OF FEB., 1988 A.D.,
AND DULY RECORDED IN PLAT BOOK
No. 62 ON PAGES 16
AND 17A 18
JOHN B. DUNKLE, CLERK
BY: *Frederick E. Conrod, III*, P.L.S.



DEDICATION

KNOW ALL MEN BY THESE PRESENTS THAT ORIOLE-BOCA, INC., a corporation in the State of Florida, owner of the land shown hereon as WHISPER WALK SECTION D, situate in Section 5, Township 47 South, Range 42 East, Palm Beach County, Florida, being a replat of a portion of Tract A of the BOUNDARY PLAT OF WHISPER WALK, A P.U.D., according to the plat thereof, as recorded in Plat Book 43, Pages 189 through 191, of the Public Records of Palm Beach County, Florida, more particularly described as follows:

COMMENCE at the Northeast corner of said Boundary Plat of WHISPER WALK, A P.U.D.;

THENCE South 00°51'10" East, along the East line of said Boundary Plat of WHISPER WALK, A P.U.D., 65.00 feet to the POINT OF BEGINNING, said point being on the South right-of-way line of the L.W.D.D. Canal L-41 as shown on said Boundary Plat of WHISPER WALK, A P.U.D.

THENCE continue South 00°51'10" East, along said East line, 1,115.56 feet;

THENCE North 89°55'48" West, 698.77 feet;

THENCE North 48°39'35" West, 32.98 feet to a point on the Easterly right-of-way line of Whisper Walk Boulevard East, as shown on the plat of WHISPER WALK ROADWAY, PLAT NO. 2 as recorded in Plat Book 53, Pages 94, 95 and 96 of said Public Records, said point also being on the arc of a non-tangent curve concave to the Southwest, a radial line through said point bears South 82°36'37" West;

THENCE Northwesterly along said right-of-way line and the arc of said curve, having a radius of 540.00 feet, a delta of 114°25'43", a distance of 1,078.46 feet to a Point of Reverse Curvature;

THENCE Southwesterly along said right-of-way line and along the arc of said curve concave to the Northwest, having a radius of 910.00 feet, a delta of 40°04'20", a distance of 636.45 feet to the Southeast corner of WHISPER WALK SECTION B, PLAT NO. 2, according to the plat thereof, as recorded in Plat Book 53, Pages 97 and 98 of said Public Records;

THENCE North along the East boundary of said WHISPER WALK SECTION B, PLAT NO. 2, a distance of 830.72 feet to the South right-of-way line of said L.W.D.D. L-41 canal;

THENCE East along said South right-of-way line, 2,137.57 feet to the POINT OF BEGINNING.

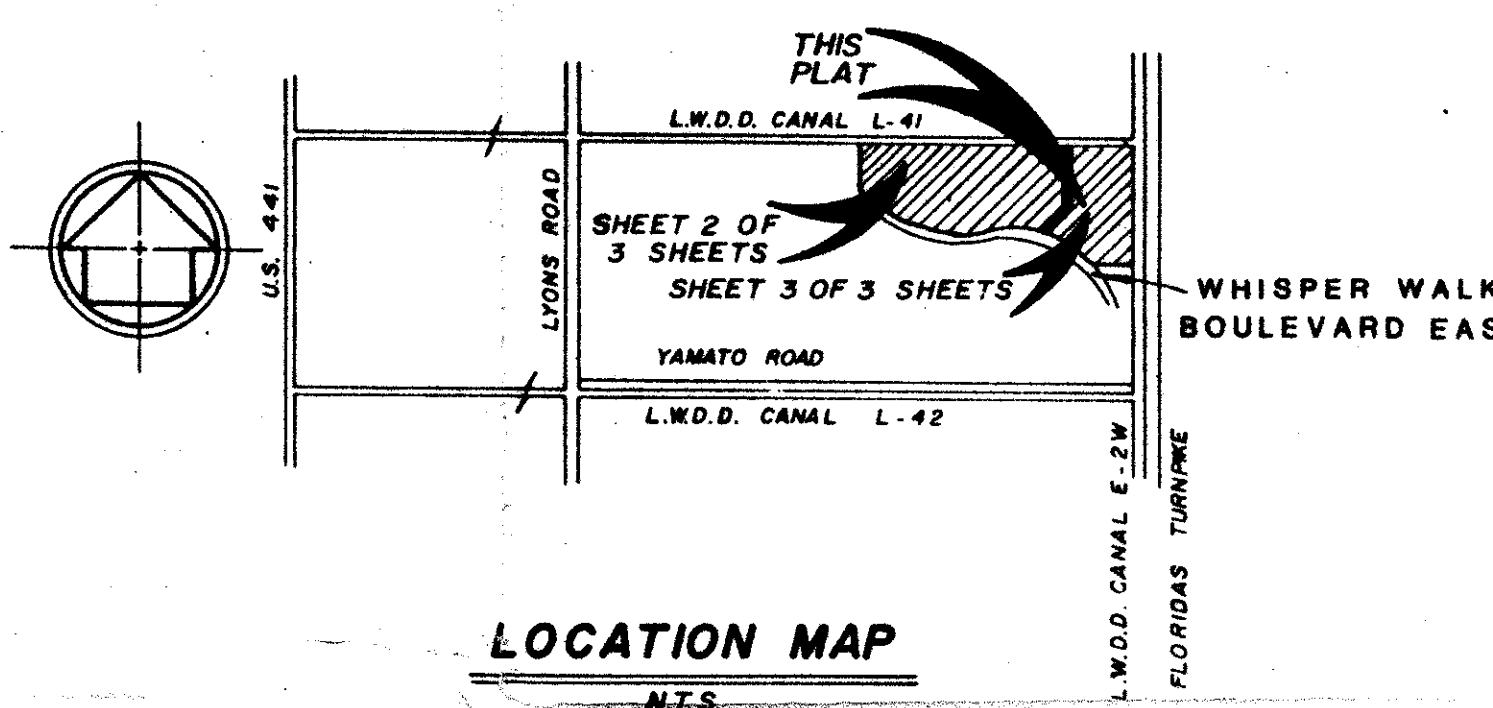

- Said lands lying in Palm Beach County, Florida, containing 42.853 acres, more or less.
- HAVE CAUSED THE SAME TO BE SURVEYED AND PLATTED AS SHOWN HEREON AND DO HEREBY DEDICATE AS FOLLOWS:
- Tracts A, O and B as shown hereon, are hereby dedicated to WHISPER WALK ASSOCIATION, INC., its successors and assigns, and shall be the perpetual maintenance obligation of WHISPER WALK ASSOCIATION, INC., its successors and assigns, for private roadway purposes, without recourse to Palm Beach County.
 - Tracts M, N and U as shown hereon are hereby reserved unto Oriole-Boca, Inc. to be established as common element or association property for "WHISPER WALK SECTION D ASSOCIATION, INC." pursuant to Florida Statute 718 for ingress, egress, utility, drainage and other purposes, and shall be the maintenance responsibility of Oriole-Boca, Inc. until such time as said Tracts become the maintenance responsibility of "WHISPER WALK SECTION D ASSOCIATION, INC.", its successors and assigns, without recourse to Palm Beach County.
 - The utility easements as shown hereon are hereby dedicated in perpetuity for the construction and maintenance of utility facilities. Such easements shall also be easements for the construction, installation, maintenance and operation of cable television services; provided, however, no such construction, installation, maintenance and operation of cable television services shall interfere with the facilities and services of an electric, telephone, gas or other public utility.
 - The drainage easements shown hereon are hereby dedicated to, and shall be the perpetual maintenance obligation of "WHISPER WALK SECTION D ASSOCIATION, INC.", its successors and assigns, for the construction and maintenance of drainage facilities, without recourse to Palm Beach County. Palm Beach County reserves the right, but not the obligation, to maintain those portions of the privately dedicated drainage system that serves to drain surface waters from any public land.
 - Tracts C, D, E, F, G, H, I, J and K are hereby reserved unto Oriole-Boca, Inc. for residential housing and other proper proper purposes and shall be the maintenance obligation of Oriole-Boca, Inc. until such time as said Tracts become the maintenance responsibility of WHISPER WALK SECTION D ASSOCIATION, INC., its successors and assigns, without recourse to Palm Beach County.
 - Tracts L-1 and L-2, the Water Management Tracts are hereby dedicated as drainage easements to "WHISPER WALK ASSOCIATION, INC." and "WHISPER WALK SECTION D ASSOCIATION, INC." and shall be available to said associations, their respective successors or assigns, and shall be the perpetual maintenance obligation of WHISPER WALK ASSOCIATION, INC., its successors or assigns without recourse to Palm Beach County.
 - The Limited Access Easements (L.A.E.) shown hereon are hereby dedicated to the Palm Beach County Board of County Commissioners for control and jurisdiction over access rights.
 - The Lake Maintenance Easements are hereby dedicated to WHISPER WALK ASSOCIATION, INC., its successors and assigns for access to and maintenance of the Water Management Tracts and are the perpetual maintenance obligation of WHISPER WALK ASSOCIATION, INC., its successors and assigns, without recourse to Palm Beach County.
 - Tracts P, Q, R and S are hereby reserved unto Oriole-Boca, Inc. to be established as common element or association property for "WHISPER WALK SECTION D ASSOCIATION, INC." pursuant to Florida Statute 718 for landscape and buffer purposes and shall be the maintenance responsibility of Oriole-Boca, Inc. until such time as said Tracts become the maintenance responsibility of WHISPER WALK SECTION D ASSOCIATION, INC., its successors and assigns, without recourse to Palm Beach County.
 - Tract T, hereby reserved unto Oriole-Boca, Inc., to be established as a recreation area and used for recreational purposes and for the use and enjoyment of WHISPER WALK SECTION D ASSOCIATION, INC., its successors and assigns and shall be the maintenance obligation of Oriole-Boca, Inc. until such time as said Tract becomes the maintenance responsibility of WHISPER WALK SECTION D ASSOCIATION, INC., its successors and assigns, without recourse to Palm Beach County.

IN WITNESS WHEREOF, ORIOLE-BOCA, INC., a Florida corporation in the State of Florida has caused these presents to be signed by its President and attested to by its Assistant Secretary and its corporate seal to be affixed hereto by and with the authority of its Board of Directors.

This 1st day of December, 1987.
Attest: *Mark A. Levy* Assistant Secretary By: *Mark A. Levy* President

ACKNOWLEDGEMENT

STATE OF FLORIDA) S.S.
COUNTY OF BROWARD)

Before me personally appeared MARK A. LEVY and A. NUNEZ to me well known and known to me to be the individuals described in and who executed the foregoing instruments as President and Assistant Secretary of ORIOLE-BOCA, INC., a corporation in the State of Florida, and acknowledged to and before me that they executed said instrument as such officers of said corporation, and that the seal affixed hereto is the Corporate Seal of said corporation and that it was affixed hereto by due and regular corporate authority, and that said instrument is the free act and deed of said corporation.

Witness my hand and official seal this 1st day of December, 1987.

My Commission Expires: Sept. 1, 1990
Nancy E. Yaght
Notary Public

TITLE CERTIFICATE

STATE OF FLORIDA) S.S.
COUNTY OF BROWARD)

I, Edward F. Joyce, do hereby certify that I have examined the title to the hereon described property; that I find the title to the property is vested to ORIOLE-BOCA, INC., a Florida corporation; that the current taxes have been paid; and that there are no encumbrances of record.

ALPHA TITLE COMPANY
Date: January 13, 1989
By: *Edward F. Joyce*
Edward F. Joyce, Vice President

P.U.D. DATA	
GROSS AREA	42.853 Ac
TOTAL No. OF DWELLING UNITS	256 UNITS
GROSS DENSITY	5.97 UNITS/ACRE

COUNTY ENGINEER

This plat is hereby approved for record this 7 day of Feb., A.D., 1988.

By: *Herbert Kahler, PE*
Herbert Kahler, PE
Palm Beach County Engineer

APPROVALS BOARD OF COUNTY COMMISSIONERS PALM BEACH COUNTY, FLORIDA

This plat is hereby approved for record this 7 day of Feb., 1988.

Attest: JOHN B. DUNKLE, CLERK
By: *Karen Marcus*
KAREN MARCUS
CHAIRMAN

SURVEYOR'S CERTIFICATE

This is to certify that the plat shown hereon is a true and correct representation of a survey made under my responsible direction and supervision and that said survey is accurate to the best of my knowledge and belief and that (P.R.M.'s) Permanent Reference Monuments have been placed as required by law and Permanent Control Points (P.C.P.'s) will be set under the guarantees posted with Palm Beach County for the Required Improvements and further that the survey data complies with all the requirements of Chapter 177 Florida Statutes, as amended, and ordinances of Palm Beach County, Florida, Minimum Technical Standards Chapter 21-BH-6, Florida Administrative Code.

12/07/87
Date
Frederick E. Conrod, III
Frederick E. Conrod, III
Professional Land Surveyor
Florida Registration No. 2816

DEDICATION (ORIOLE-BOCA INC.)	ACKNOWLEDGEMENT (NOTARY)	COUNTY ENGINEER	SURVEYOR
<i>Mark A. Levy</i>	<i>Nancy E. Yaght</i>	<i>Herbert Kahler, PE</i>	<i>Frederick E. Conrod, III</i>

Pet. 80-229
O'Connell schools see att'd letter 5/24/88

WHISPER WALK SECTION "D"

TAZ 770
Whisper Walk D
62 B
53
2157
AS 80-229
38434
5/27/88
PUP NAME